

100W High Torque DC Motor Drum Drive Roller Conveyor Roller For Linear Conveyors

Our Product Introduction

for more products please visit us on drum-roller.com

Basic Information

- Place of Origin: China Jiangsu
- Brand Name: Winroller
- Certification: CE, ROHS2.0, EMC, ISO9001
- Model Number: Winroller 100W High Torque DC Motor Drum Drive Roller Conveyor Roller
- Minimum Order Quantity: 1 stick
- Price: Contact Us
- Packaging Details: Wooden case
- Delivery Time: 7-15 word days
- Payment Terms: TT, L/C
- Supply Ability: 1000000/year



Product Specification

- Product Name: 100W High Torque DC Motor Drum Drive Roller Conveyor Roller
- Motor Type: DC Brushless Gear Deceleration Motor Drum
- Power: 80W / 100W
- Dimensions: 50mm In Diameter
- Voltage: DC24V / DC48V
- Rated Speed: 0.87~120m/min
- Maximum Load: 400kg
- Applications: Linear Conveyors, Small Belt Conveyors, Zero Pressure Accumulation Conveyors,
- Protection Class: IP54
- Pipe: Galvanized Steel, Stainless304
- Highlight: **High Torque DC Motor Roller, Linear Conveyors DC Motor Roller, 100W Motor Drive Roller**



More Images



Product Description

100W High Torque DC Motor Drum Drive Roller Conveyor Roller For Linear Conveyors

Features Overview of 100W High Torque DC Motor Drum Drive Roller Conveyor Roller

The High Torque Motor Drum Roller features a robust 100W brushless motor, engineered to deliver high torque for heavy-duty applications. Its powerful performance ensures smooth and efficient handling of large loads, making it ideal for industrial environments that require consistent torque output. With its energy-efficient design and low noise operation, this motor drum roller is perfect for applications where high torque and reliable control are essential.

Function of 100W High Torque DC Motor Drum Drive Roller Conveyor Roller

The **High Torque DC Motor Drum Drive Roller** is designed to provide reliable and efficient power for conveyor systems and automated material handling applications. Equipped with a **high-torque DC motor**, it offers powerful drive capabilities, ensuring smooth and consistent movement of products, even in heavy-duty environments. The roller is ideal for high-load conditions, enabling the transport of bulky items such as pallets, boxes, and heavy containers.

One of the key functions of this motor drum roller is its ability to **adjust speed precisely**, making it versatile across various conveyor setups. Whether it's a fast-moving sorting line or a slow, steady accumulation process, the roller can be fine-tuned to match the specific operational needs. This adaptability makes it particularly useful in logistics, manufacturing, and packaging systems where precise control is required to maintain efficiency.

Additionally, the **brushless DC motor** ensures that the roller operates with minimal maintenance, providing a longer lifespan and reducing the wear and tear typically associated with traditional motorized systems. The motor's high torque output makes it suitable for overcoming start-stop cycles, inclines, or high-friction scenarios, further enhancing its functionality in demanding industrial settings.

Application of 100W High Torque DC Motor Drum Drive Roller Conveyor Roller

Logistics and Warehousing: Efficiently handles the movement of heavy cartons, pallets, and containers in sorting and distribution systems.

Manufacturing Assembly Lines: Provides reliable torque for moving products along automated assembly lines, ensuring smooth and continuous production.

Packaging Industry: Ideal for driving conveyors in packaging systems, supporting high-speed and precision-driven operations.

Material Handling: Capable of transporting bulk materials and large items in industrial settings, offering consistent performance under heavy loads.

Zero-Pressure Accumulation (ZPA) Conveyors: Ensures jam-free and smooth operation in accumulation conveyors, perfect for sensitive product handling.

E-commerce Fulfillment Centers: Facilitates the fast and efficient transfer of goods, supporting high-volume order processing and fulfillment.

Food and Beverage Processing: Suitable for hygienic environments with stainless steel options, ensuring safe transport of food products.

Technical Parameters of 100W High Torque DC Motor Drum Drive Roller Conveyor Roller

100W High Torque DC Motor Drum Drive Roller Conveyor Roller

Motor Type	DC brushless gear deceleration motor drum	Power	80W / 100W
Dimensions	50mm in diameter	Voltage	DC24V / DC48V
Rated Speed	0.87~120m/min	Maximum Load	400kg
Protection Class	IP54	Pipe	Galvanized steel, stainless304
Applications	Linear Conveyors, small belt conveyors, zero pressure accumulation conveyors,		

Φ50 DC series electric roller

Low speed and high torque

The roller will be equipped with professional driver for forward and reverse control and speed control.



MODULAR CORE

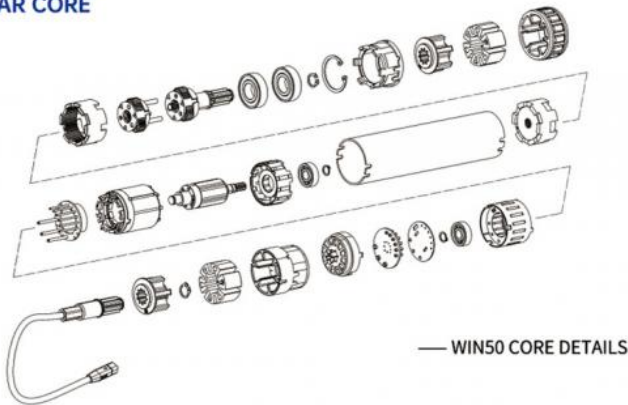

— WIN50 CORE DETAILS

BASIC TECHNICAL PARAMETERS

Voltage	DC24V				DC48V			
	Standard		Enhanced		Standard		Enhanced	
Motor type	S1	S2	S1	S2	S1	S2	S1	S2
Working system								
Rated power	40W	50W	80W	100W	40W	50W	80W	100W
Rated current	3A	3.5A	6A	6.8A	1.5A	1.8A	3.2A	4.0A
Starting current	6A	7.0A	11.6A	13.6A	3.0A	3.6A	6.6A	8.0A
Unload running noise	(≤ 55dB)							
Standard cable length	1000mm							
Tube length	300~1500mm							
Working ambient temperature	-30℃ ~60℃							
Motor shaft	d12mm							
Anti-Static	yes							
Shell I thickness	1.5mm							
Shell material	X:galvanized steel S3:stainless304							
Shell outside coat	P:PU coated JT:sleeve JZ:rubber JP:PVC JG:silicone							

Note: Switch S1/S2 working system through the controller dip switch function.

N: M8 internal thread

BL50 Linkage mode



DRIVE MODE

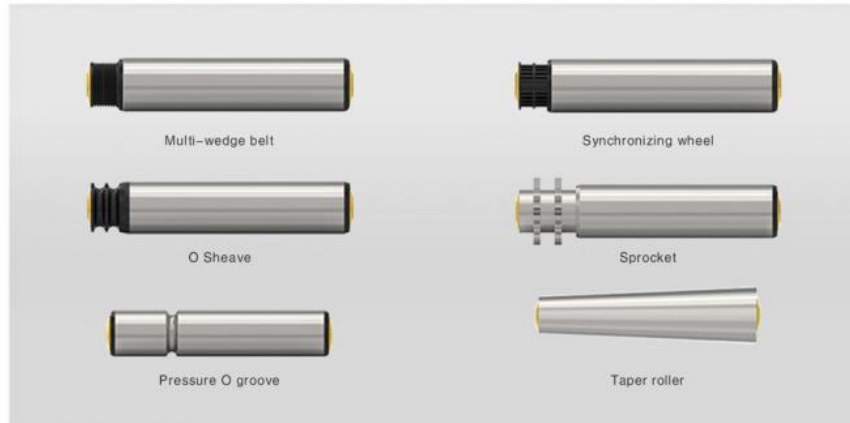

BL50 Surface treatment

The standard model of the electric drum designed by our company is not covered by glue by default. If you need, we can do the glue wrapping treatment. The glue surface has plane, herringbone, diamond pattern, etc; Most specifications can have additional functions; For example, in different environments, the exposed parts such as shaft and barrel can be made of wear-resistant and corrosive materials, stainless steel, etc. Silica gel for food industry is food grade. Waterproof roller can be selected for those with waterproof requirements.

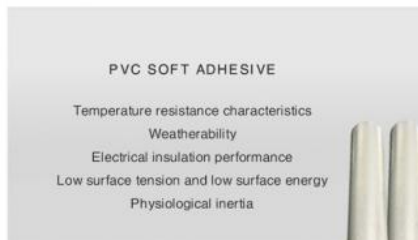
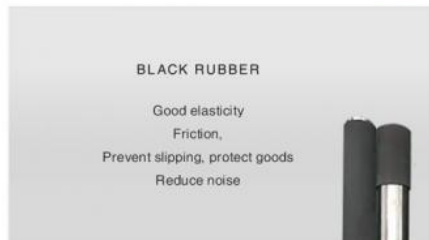
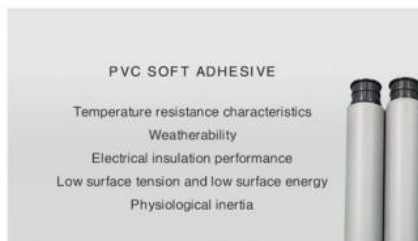

Note : It's just the typical technical data for you reference, The specification such as voltage, speed, torque, shaft can be customized by your needs. Please contact us for more details. Thanks.

Feature Picture of 100W High Torque DC Motor Drum Drive Roller Conveyor Roller





WIN ROLLER JIANG SU Winroller Technology Co., Ltd.



+86 18168399322



winroller.market@gmail.com



drum-roller.com

No. 7, Xiye Road, Huishan District, Wuxi City, Jiangsu Province, China